

ORBIS Europe

INNOVATIVE PACKAGING SOLUTIONS
...for a sustainable future

ORBIS

Powered by Menasha Corporation

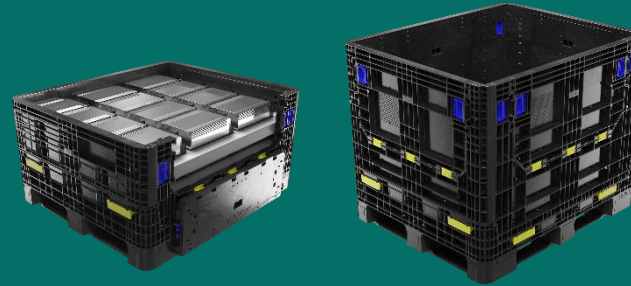

DISCLAIMER: These materials are proprietary, confidential, for discussion purposes only, and intended solely for the use of ORBIS Corporation ("ORBIS"), its affiliates, and their respective shareholders, directors, officers, and employees. ORBIS disclaims any express or implied warranties concerning the accuracy, reliability, or completeness of, and accepts no liability for, any information contained herein. Any views or opinions presented herein are solely those of the author(s) and do not necessarily represent those of ORBIS. If you are not the intended recipient please notify ORBIS immediately and destroy all copies. Unauthorized use or dissemination of these materials is strictly prohibited.

**INNOVATIVE****DURABLE****SUSTAINABLE**

AGENDA



About ORBIS

Product & Service Portfolio

Sustainability

ABOUT ORBIS

- ORBIS is a subsidiary of Menasha Corporation
- Family-owned business since 1849 with 175 years of industry excellence
- World Headquarters: Oconomowoc, Wisconsin
- 5 countries in North America and Europe
- More than 50 locations and service centers
- 3,300+ employees



WHY ORBIS?

175

Years of
Manufacturing
Excellence

Responsive
and agile

Responsive,
insightful and
accessible
trusted leader

50+

Sales, Service and
Manufacturing
Locations in
North America
and Europe

Innovation

Innovative
products,
services,
materials and
solutions

3.300

Associates in
U.S., Latin
America, Canada
and Europe

POWER BEHIND POSSIBLE

- The Menasha Corporation is Family-Owned for **7 Generations**
- Founded in 1849
- Sister Company: Menasha Packaging, ORBIS Corporation
- 6000 Employees, 100 Locations
- A Legacy of **Social Responsibility** – 3-Tiered Approach:
 - Economic Value
 - Social Responsibility
 - Environmental Stewardship and Circular Economy





— 175 YEARS —
MENASHA
CORPORATION
— SINCE 1849 —

 **Menasha** 

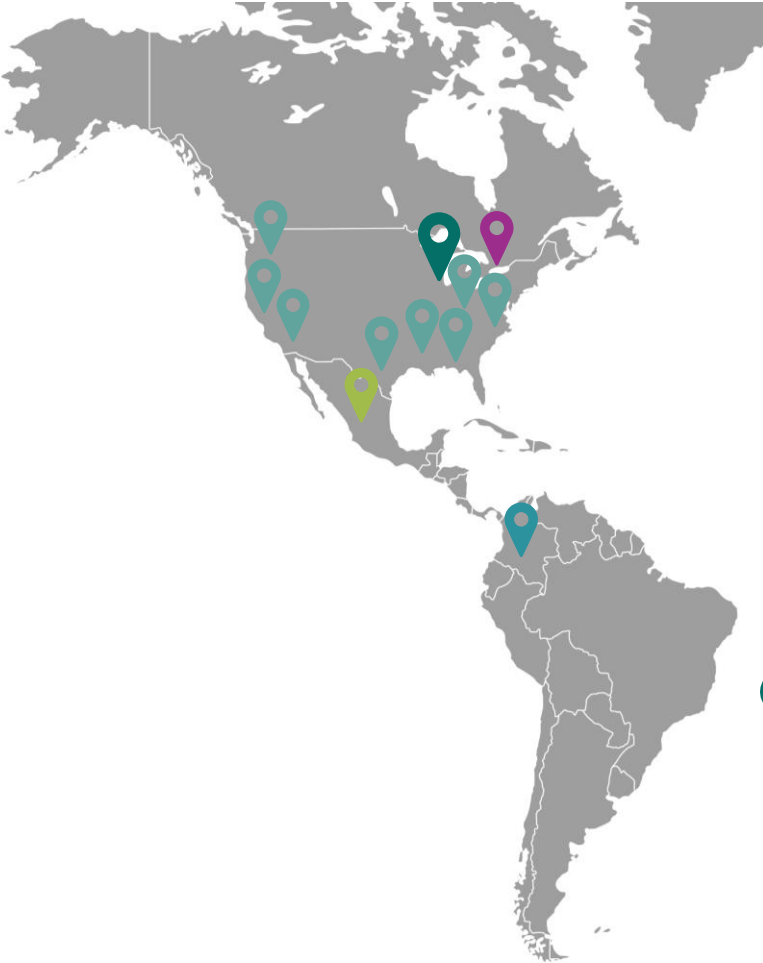



LOCATIONS



-  Oconomowoc, Wisconsin
US Headquarters
-  United States of America
Production, Sales, RPM Service Centers
-  Toronto, Ontario, Canada
Production
-  Mexico
Production, Sales, RPM Service Center
-  Columbia
Sales FMCG and Beverage

In Europe since 2016

-  Hürth / Cologne, Germany
European Headquarters
-  Ieper, Belgium
Production
-  Eindhoven, The Netherlands
RPM Service Center
-  Yalova, Turkey
Production



GLOBAL MANUFACTURING FOOTPRINT

NORTH AMERICA

Just announced!
New plant in Greenville, Texas in 2024



EUROPE



- 14 represented manufacturing facilities globally
- Partnered with ~30 contract molders for regional production and incremental capacity
- Network of manufacturing partners with capabilities of expanding global production

SOLUTIONS FOR GLOBAL SUPPLY CHAINS

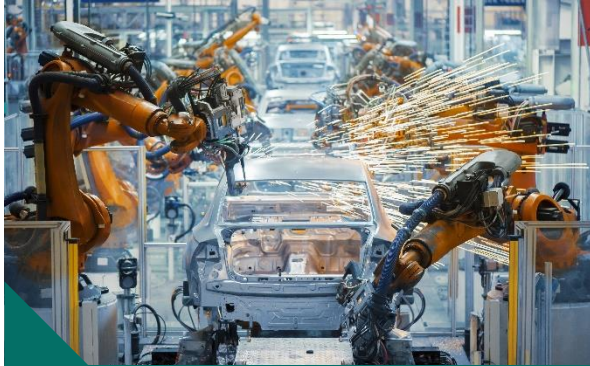

Automotive



Battery



Industrial

e.g. agricultural machinery, railway



Beverage



Food



FMCG

ORBIS EUROPE SERVICE OFFERING

Integrated solutions to meet
your supply chain needs



Expanding Range of
Reusable Packaging Solutions



Unbiased Design Solutions and
Customer-Specific Developments



Global Team of Universal
Subject Matter Experts



Reusable Packaging Management
Solutions (availability based on project)



Global
Coverage



Engineering
Services

Leading in USA, Canada and Mexico – growing presence in Europe

PRODUCT PORTFOLIO – RSC



Food & Beverage Pallets

- For aluminium cans, glass/plastic bottles
- Load capacity 10.000 kg static
- Layer pads and top frames available
- Different footprints available

Services

- Qualified consulting
- Customer-specific packaging solutions
- Global support

PlastiCorr®

- Drop-in replacement for fibre corrugated boxes in automated packaging lines
- No changes to pack count and logistics needed
- Repeatable, reliable performance
- Applications: inbound, finished goods



PRODUCT PORTFOLIO -INDUSTRIAL



BulkPak® – Industrial Bulk Bins

- Efficient alternatives to conventional packaging, e.g. metal / wood boxes
- Standard footprints:
1200 x 800 / 1200 x 1000 / 1600 x 1200
- Weight capacity of up to 900 kg
- Foldable and stackable design

IonPak® – Dangerous Goods Packaging

- UN-Certified plastic container with inner packaging
- Certified to transport solid dangerous goods
- Approval up to 520-915 kg gross weight
- Different footprints available

Services

- Qualified consulting e.g. by certified dangerous goods advisors
- Customer-specific packaging solutions
- Global support

PRODUCT PORTFOLIO – NORTH AMERICA



Bulk Packaging

- Strength and rugged durability for industrial/automotive applications
- Foldable and stackable design
- Footprints from 32" x 30" to 78" x 48"
- Available in many styles, e.g. collapsible

Hand-Held Containers/Totes/Bins

- Reduces waste associated with single-use boxes
- Drives automation efficiency and improves worker safety
- Footprints from 12" x 7" to 48" x 22"
- Available in many styles, e.g. collapsible,

Racking and Distribution Pallets

- Conversion from wood to plastic pallets
- For work-in-process, storage and distribution applications
- Footprints from 20" x 28 to 48" x 72"
- More than 150 different styles/models



ENGINEERING SERVICES & CUSTOM SOLUTIONS

- ✓ Reusable packaging programs for long-term savings and sustainability
- ✓ Environmental and economic analysis (e.g. LCA / TCO)
- ✓ Standard and customised container development
- ✓ In-house dunnage design capabilities for part protection and pack density (e.g. EPP)
- ✓ Qualified consulting according RID/ADR, incl. project management & UN certification

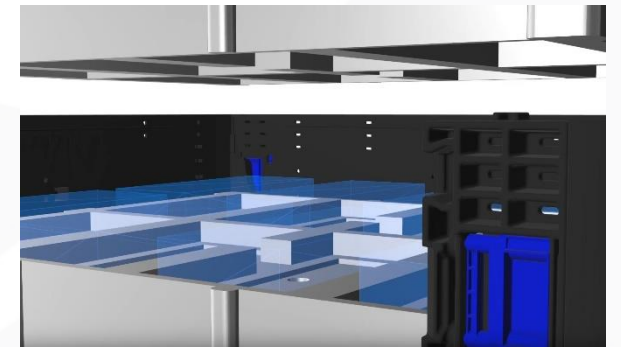
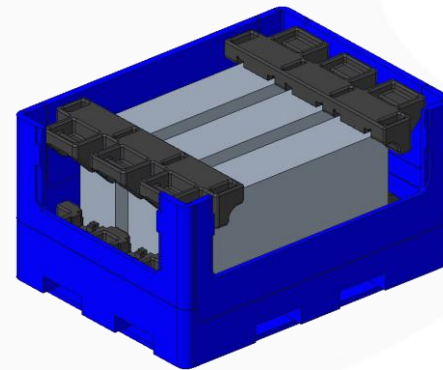

FROM STEEL TO PLASTIC

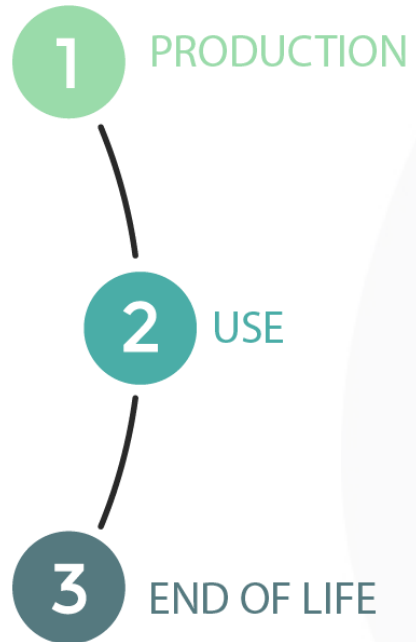

36 kg CO₂ savings
per FLC due to use of recycled material¹

800 kg CO₂ savings
per return transport due to foldable design²

100% recyclability
of raw materials at end of life



Exemplary calculation.

¹ <https://walmartsustainabilityhub.emissionscalculators.walmart.com/main/home/GSF/eng/packaging>

² <https://www.carboncare.org/co2-emissions-rechner.html> – per 1.000 km

FROM WOOD TO PLASTIC

Improved workplace safety
and ergonomics



800 kg CO₂ savings
per return transport due to foldable
design¹

Durable over a long service life
due to robust design and repairability



All plastic design
is easy to clean with no mould or splinters



¹ <https://www.carboncare.org/co2-emissions-rechner.html> – per 1.000 km

A BETTER WORLD – THROUGH SUSTAINABLE PACKAGING

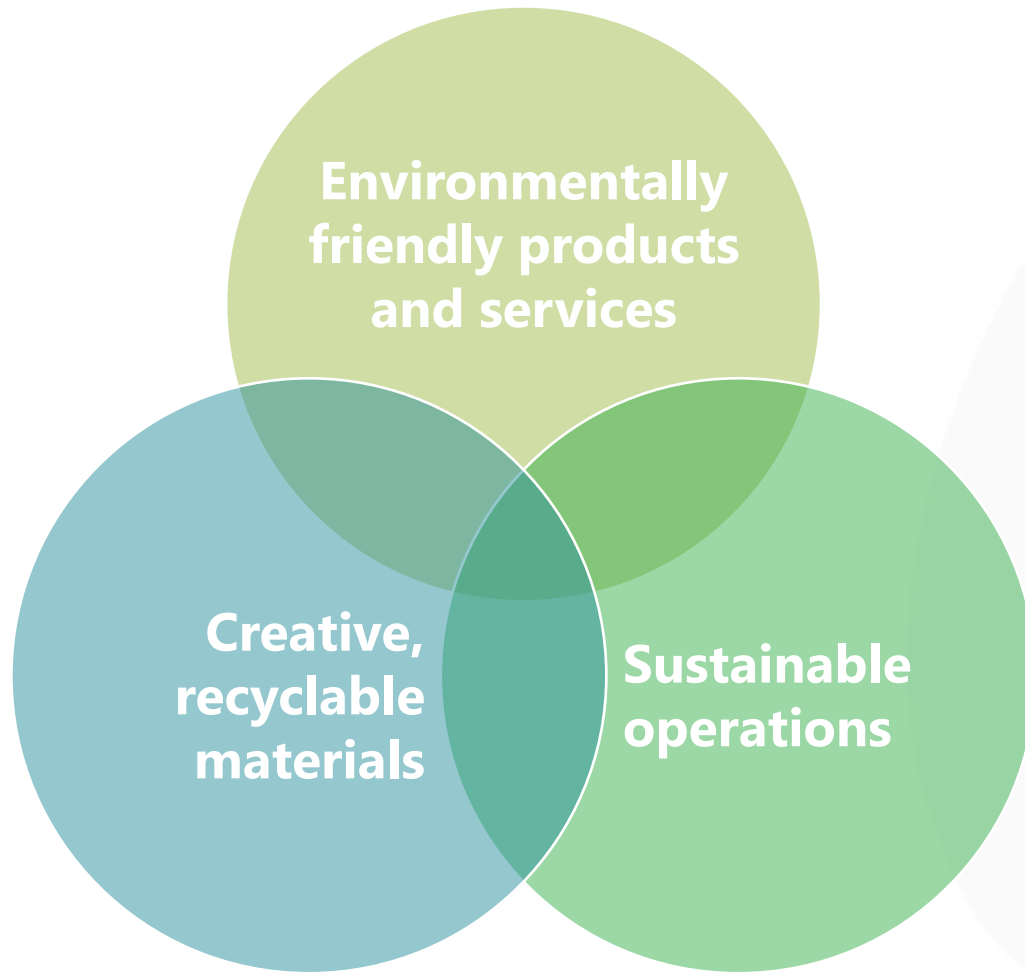

- A more sustainable business starts with the supply chain and how product and parts are stored, handled, transported and delivered.
- The **circular economy concept** – which is based on a continuous flow of product in the value circle – is the future of a successful, sustainable supply chain.



REDUCE



REUSE



RECYCLE



REPURPOSE

WHY REUSABLES



OUR CIRCULAR ECONOMY

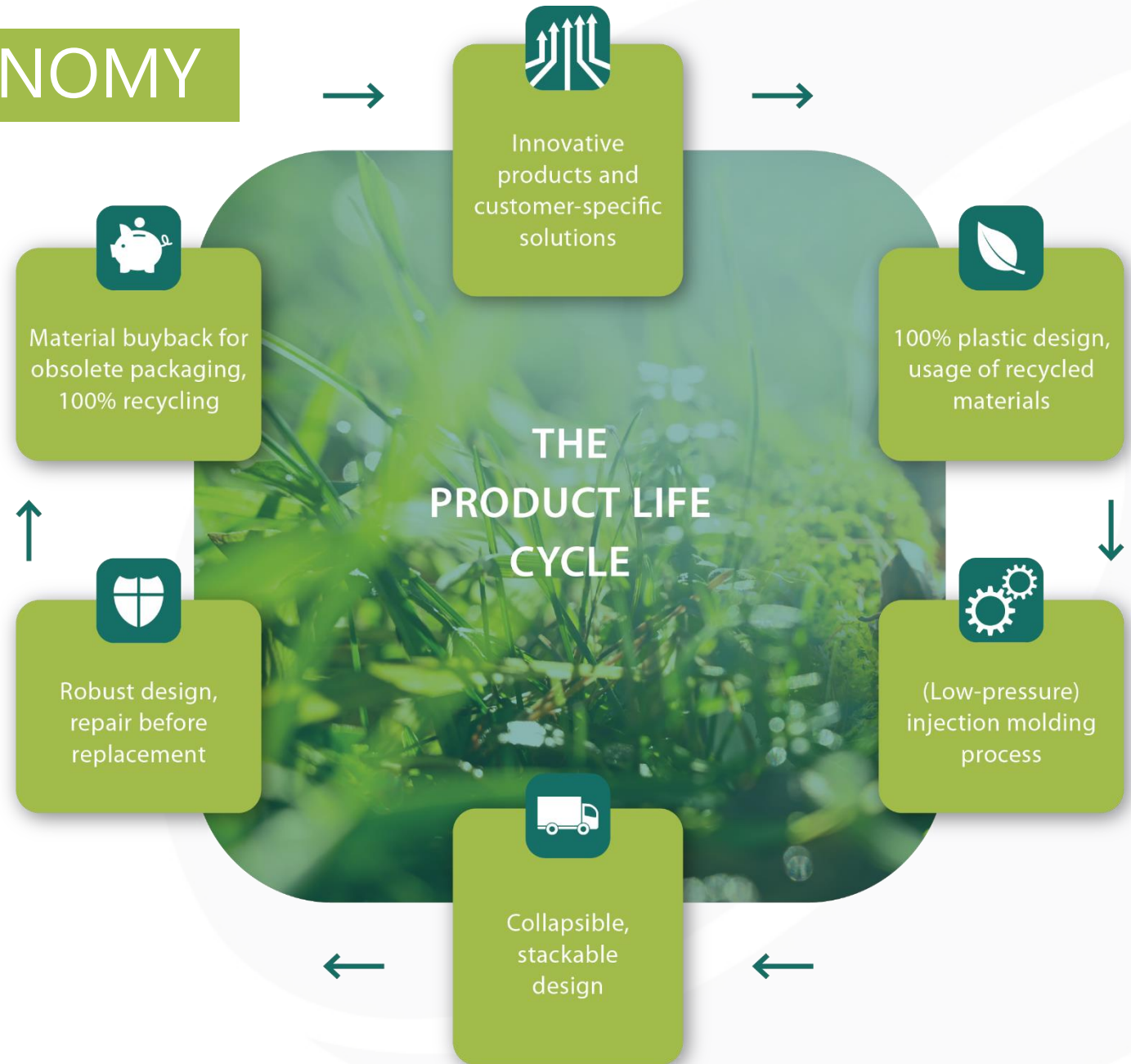

SUSTAINABILITY AT ORBIS

1. Green product design for more sustainable supply chains



REDUCE

Reusables are designed to lessen waste, emissions and energy use.¹



REUSE

Plastic packaging is durable and reusable over several years.



RECYCLE

Manufactured, used and recycled with no solid waste.



REPURPOSE

Recycled materials are repurposed for new production.

2. Reducing the use of resources in our own operations

Greenhouse gas emissions



Water usage



Solid waste



¹As proven using Franklin and Associates life-cycle

RECYCLE WITH ORBIS

- **Comprehensive recycling program** for the efficient recovery of obsolete and surplus packaging
- By design, plastic reusable packaging can be fully recycled and used in other useful products at the end of its service life – without entering the solid waste stream.
- Buyback option for end-of-life plastic packaging (HDPE & PP)
→ **Receive credit** for future purchases
- Exemplary calculation:
28,99€ net present value at time of purchase

Weight	Price / kg ¹	Credit	Transport ²	Disposal ³	Interest Rate	NPV
65 kg	0,58 €	37,70 €	5,68 €	0,00 €	1,0 %	28,99 €

¹ Based on value of 03/2022.

² Transportation from South Germany to ORBIS Plant Belgium: 1.500 € / 264 Bins = 5,68 € per Bin.

³ The raw materials are 100% recyclable, no disposal costs.

LIFE CYCLE ASSESSMENT TOOL

- ORBIS' Packaging Life-Cycle Assessment (LCA) capabilities help companies evaluate the impact that reusable packaging has on the environment.
- **Data-driven** approach, measuring the impact of packaging through every phase of its life – from natural resource extraction to end-of-life
- Outputs include greenhouse gas **emissions**, **water** usage, solid **waste** and **energy** usage
- Easy process with clear, concise and sharable results
- Simple inputs include product weight, trip distance, trip number, etc.
- Assessments are **customized** and calculations are specific to your unique application
- Utilizes **ISO certified** life-cycle data, provided by a 3rd party LCA research firm

3 Easy Step Process

Inputs of Customer
Supply Chain Data

ORBIS Processes
Data

Full Report to
Customer

SUSTAINABILITY IN US OPERATIONS

Menasha and ORBIS are committed to taking tangible steps to reduce our environmental impact and nurture the circular economy. The **“30 by 30” goal** is to...



... reduce water use by **10 %**



... reduce landfill waste by **10 %**



... reduce total emissions by **10 %**

per production ton no later than 2030.¹

¹2020 baseline

**Leading the way
to a sustainable
future.**

OCEAN IN MIND

- The Ocean in Mind program reclaims and reuses plastic material recovered near major waterways.
- Initiative focuses on **recovering and repurposing** single-use plastic waste found on coastlines and using it in supply chain packaging.
- By definition, this is single-use **plastic waste** recovered within 32 miles from a coastline.



REPURPOSING PLASTIC WITH THE
OCEAN IN MIND

FROM COASTLINES

Single-use
plastic waste
collected from
coastlines



Reprocessed into
reusable resin



Manufactured into
reusable packaging
solutions

TO PACKAGING SOLUTIONS

Connect with us!

INNOVATIVE PACKAGING
SOLUTIONS

...FOR A SUSTAINABLE FUTURE



 **Powered by** Menasha Corporation

